

# Product

## T37 Series

*New!*

*T-Bolt Metal Drawer Lock  
National D4291 Keyway*

Introducing... The **T37 Series** T-bolt Lock  
*The industry's first easily rekeyable T-bolt lock  
for metal bank drawers.*

### **Directly replaces National C8137!**

**Keyway:** Available in National D4291 (4-pin) keyway. KA, KD or MK.

**Rekeyable:** Working top-slide, patented "cylinder retainer staple" and removable bezel ring make rekeying fast and easy. No more need to pry off faceplates and pin retainer clips.

**Stronger bolt:** Our stainless steel bolt will withstand repeated abuse without breaking.

**Retrofits:** National C8137.

**Mounting:** Ships standard with brass fixing nut.

**Spring clip:** Optional spring clip is available for clip mounting if desired. The lock comes standard with clip mounting locations for 0" to 11/64" material thicknesses.



US Patent No.  
5,038,589

**Looking for that hard to find key code for LeFebure,  
Diebold or Mosler? We've got you covered!**

**OLYMPUS**  
**LOCK, INC.**

*The cabinet lock innovators.*

18424 Highway 99 • Lynnwood, WA 98037  
Phone 206-362-3290 • Toll-free 800-525-0954 • Fax 206-362-3569  
[www.olympus-lock.com](http://www.olympus-lock.com) • [info@olympus-lock.com](mailto:info@olympus-lock.com)

Data Sheet

# T37 SERIES



## T-Bolt Metal Drawer Lock National D4291 Keyway

### General Specifications

#### T37 Series T-Bolt Lock

**Rekeyable:** Easily rekeyable via working top slide and patented retainer staple cylinder removal mechanism

**Retrofits:** National C8137

**Body:** Zinc die cast

**Bolt:** Stainless steel

**For material:** 1/4"

**Barrel diameter:** 3/4"

**Across flats:** 5/8"

**Finish:** US26D (satin chrome)

**Cylinder:** National D4291 keyway

**Keying:** KA/KD/MK (4 pin), stock KA Nos. 101, 103, 107, 915 and 001 through 030. Master and/or custom keying available.

#### Available Separately

**T37-RC** - Spring mounting clip

Use of spring clip allows lock to fit material thicknesses of 0" to 11/64"

**T37-NKIT** - Number ring package

**T37DC-NP** - Number plate only

**T37-2** - Long bolt

**T37-3** - "Chicago-style" short bolt for 25/32" backset

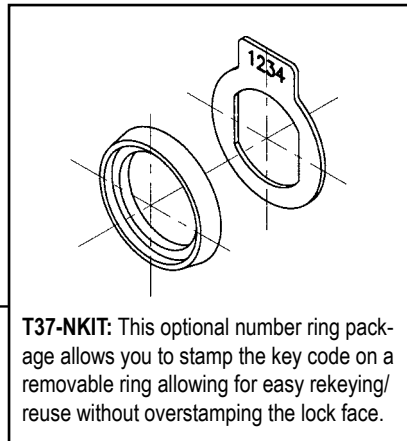
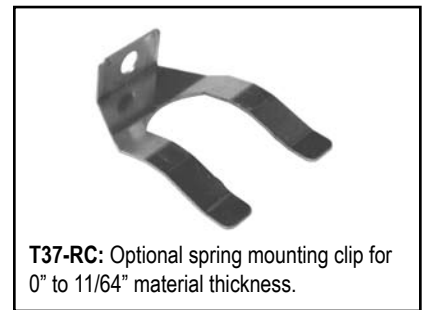
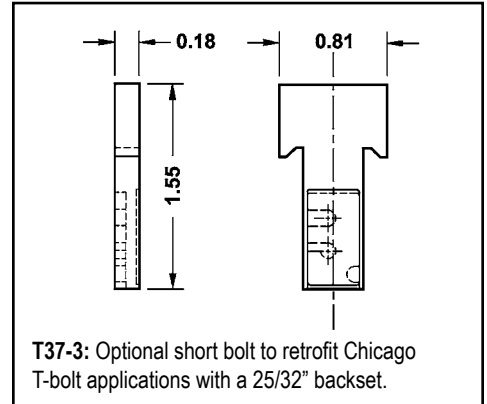
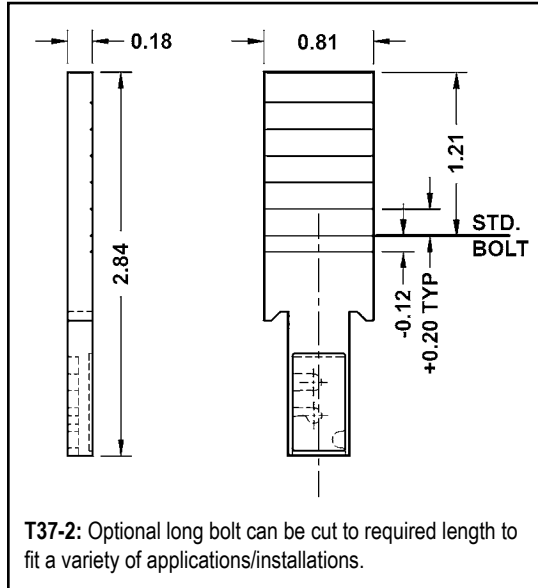

### T37 Lock Dimensions

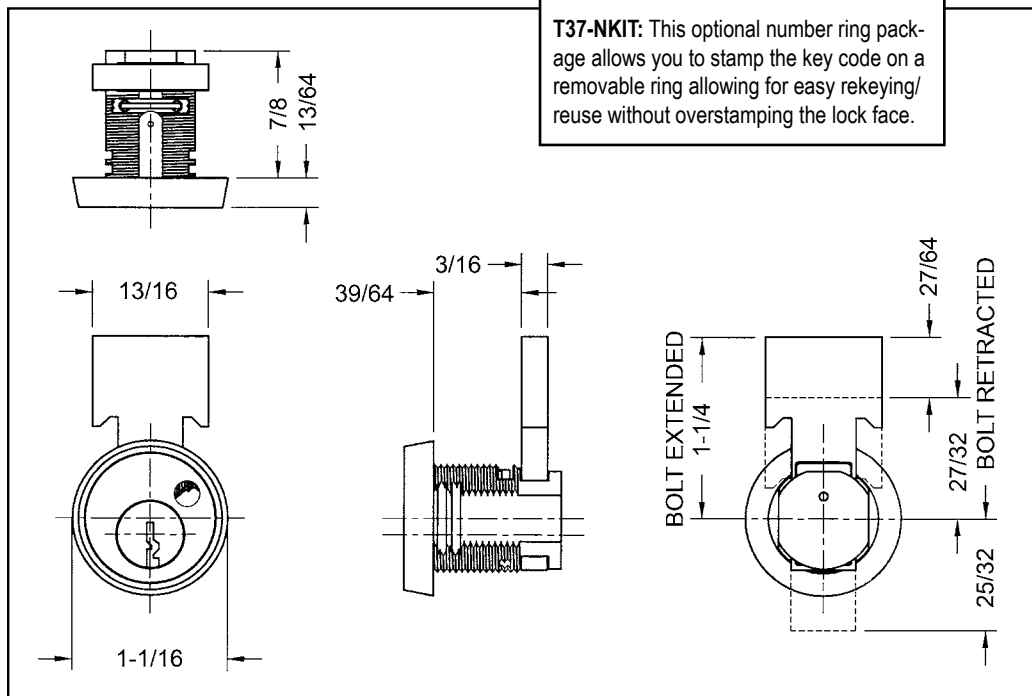

### T37 Mounting Dimensions

